

## DS-2XT6645G0-LIZS/C15 4 MP High Temperature Camera



- High quality imaging with 4 MP resolution
- Air-cooling double-layer 304 stainless steel protective cover with high-temperature resistance (ambient temperature  $\leq 150^{\circ}\text{C}$  (302  $^{\circ}\text{F}$ )), supporting air curtain structure and effective dust removal
- Clear imaging against strong back light due to 120 dB true WDR technology
- Water and dust resistant (IP68)
- Easy installation with Power over Ethernet (PoE) technology and 12 VDC power input
- Supports Hikvision Embedded Open Platform (HEOP) with 1.5 TOPS computing power and importing third party applications

## ▪ Specification

Camera	
Image Sensor	1/3" Progressive Scan CMOS
Max. Resolution	2688 × 1520
Min. Illumination	Color: 0.005 Lux @ (F1.2, AGC ON), B/W: 0.001 Lux @ (F1.2, AGC ON), 0 Lux with IR
Shutter Time	1/3 s to 1/100,000 s
Day & Night	IR cut filter
Lens	
Focus	Auto,Semi-auto,Manual
Focal Length & FOV	2.8 to 12 mm, horizontal FOV 105.4° to 34.3°, vertical FOV 56.1° to 19.3°, diagonal FOV 125.8° to 39.3°
Iris Type	Fixed
Aperture	F1.2
DORI	
DORI	2.8 to 12 mm: D: 63.4 to 180.6 m, O: 25.2 to 71.7 m, R: 12.7 to 36.1 m, I: 6.3 to 18.1 m
Illuminator	
Supplement Light Type	IR,White Light
Supplement Light Range	IR: up to 30 m White Light: up to 20 m
Smart Supplement Light	Yes
IR Wavelength	850 nm
HEOP	
Open Resources	System memory: 60 MB Smart RAM: 350 MB Flash: 2 GB
Computing Power	1.5 TOPS
Deep Learning Structure	Caffe,PyTorch,TensorFlow
Programming Language	C,C++
Video	
Main Stream	50 Hz: 25 fps (2688 × 1520, 2560 × 1440, 1920 × 1080, 1280 × 720) 60 Hz: 30 fps (2688 × 1520, 2560 × 1440, 1920 × 1080, 1280 × 720)
Sub-Stream	50 Hz: 25 fps (704 × 576, 640 × 480) 60 Hz: 30 fps (704 × 480, 640 × 480)
Third Stream	50 Hz: 10 fps (1920 × 1080, 1280 × 960, 1280 × 720, 704 × 576, 640 × 480) 60 Hz: 10 fps (1920 × 1080, 1280 × 720, 704 × 480, 640 × 480)
Video Compression	Main stream: H.265/H.264 /H.265+/H.264+ Sub-stream: H.265/H.264/MJPEG Third stream: H.265/H.264
Video Bit Rate	32 Kbps to 8 Mbps
H.264 Type	Baseline Profile,Main Profile,High Profile
H.265 Type	Main Profile
Bit Rate Control	CBR,VBR
Scalable Video Coding (SVC)	H.265 and H.264 encoding
Region of Interest (ROI)	1 fixed region for main stream and sub-stream
Target Cropping	Yes

<b>Audio</b>	
Environment Noise Filtering	Yes
Audio Sampling Rate	8 kHz/16 kHz/32 kHz/48 kHz
Audio Compression	G.711ulaw/G.711alaw/G.722.1/G.726/MP2L2/PCM/AAC-LC/MP3
Audio Bit Rate	64 Kbps (G.711)/16 Kbps (G.722.1)/16 Kbps (G.726)/32 to 192 Kbps (MP2L2)/8 to 320 Kbps (MP3)
Audio Type	Mono sound
<b>Network</b>	
Simultaneous Live View	Up to 6 channels
API	Open Network Video Interface, ISAPI, SDK, ISUP
Protocols	TCP/IP, ICMP, HTTP, HTTPS, FTP, SFTP, DHCP, DNS, DDNS, RTP, RTSP, RTCP, PPPoE, NTP, UPnP, SMTP, SNMP, IGMP, 802.1X, QoS, IPv6, UDP, SSL/TLS
User/Host	Up to 32 users 3 user levels: administrator, operator, and user
Network Storage	NAS (NFS, SMB/CIFS), Auto Network Replenishment (ANR), Together with high-end Hikvision memory card, memory card encryption and health detection are supported.
Client	iVMS-4200, Hik-Connect, Hik-Central
Web Browser	Plug-in required live view: IE 8+, Chrome 41.0 to 44, Firefox 30.0 to 51, Safari 8.0 to 11 Plug-in free live view: Chrome 45.0+, Firefox 52.0+ Local service: Chrome 57.0+, Firefox 52.0+ Not recommended: Safari 11+, Edge
<b>Image</b>	
Image Settings	Rotate mode, saturation, brightness, contrast, sharpness, white balance, AGC, adjustable by client software or web browser
Wide Dynamic Range (WDR)	120 dB
Picture Overlay	LOGO picture can be overlaid on video with 128 × 128 24 bit bmp format.
Day/Night Switch	Day, Night, Auto, Schedule, Alarm Trigger
Image Enhancement	BLC, HLC, 3D DNR, Defog, Gray Scale
Image Parameters Switch	Yes
SNR	≥ 50 dB
Privacy Mask	8 programmable polygon privacy masks
<b>Interface</b>	
Ethernet Interface	1 RJ45 10 M/100 M self-adaptive Ethernet port
On-Board Storage	Built-in memory card slot, support microSD/microSDHC/microSDXC card, up to 256 GB, *You are recommended to purchase memory card together with the product if needed. After ordering, the memory card will be installed to product during manufacturing.
Audio	1 input (line in), 1 output (line out)
Alarm	1 input, 1 output (max. 24 VDC, 1 A/110 VAC, 500 mA)
Reset Key	Yes
<b>Event</b>	
Basic Event	Motion detection (support alarm triggered by specified target types (human and vehicle)), video tampering alarm, exception (network disconnected, IP address conflict, illegal login, HDD full, HDD error)

Smart Event	Line crossing detection, intrusion detection, region entrance detection, region exiting detection (support alarm triggered by specified target types (human and vehicle)) Scene change detection, audio exception detection, defocus detection, unattended baggage detection, object removal detection
Linkage	Upload to FTP/NAS/memory card, notify surveillance center, send email, trigger alarm output, trigger recording, trigger capture
<b>General</b>	
Power	Three-core terminal block, DC: 12 V, 0.94 A, max. 11.24 W, PoE: IEEE 802.3at Class 4, max. 13.37 W
Material	Front cover: plastic, body: metal
Dimension	290.8 mm × 162.5 mm × 141 mm (11.45" × 6.4" × 5.55")
Package Dimension	753 mm × 313 mm × 424 mm (29.65" × 12.32" × 16.69")
Weight	Approx. 6.245 kg (13.77 lb.)
With Package Weight	Approx. 7.96 kg (17.55 lb.)
Startup and Operating Conditions	Air cooling (with 20 °C (68 °F) air): 1. Ambient temperature 150°C (302 °F), pressure 0.1 MPa, air volume 20 m <sup>3</sup> /h, internal body temperature 54°C (129.2 °F) 2. Ambient temperature 125°C (257 °F), pressure 0.1 MPa, air volume 18 m <sup>3</sup> /h, internal body temperature 49°C (120.2 °F) 3. Ambient temperature 100°C (212 °F), pressure 0.1 MPa, air volume 14 m <sup>3</sup> /h, internal body temperature 43°C (109.4 °F) 4. Ambient temperature 85°C (185 °F), pressure 0.1 MPa, air volume 10 m <sup>3</sup> /h, internal body temperature 41°C (105.8 °F) Humidity 95% or less (non-condensing) *It is necessary to protect the cable from heat when the ambient temperature of the cable is above 120 °C (248 °F).
Language	33 languages: English, Russian, Estonian, Bulgarian, Hungarian, Greek, German, Italian, Czech, Slovak, French, Polish, Dutch, Portuguese, Spanish, Romanian, Danish, Swedish, Norwegian, Finnish, Croatian, Slovenian, Serbian, Turkish, Korean, Traditional Chinese, Thai, Vietnamese, Japanese, Latvian, Lithuanian, Portuguese (Brazil), Ukrainian
Linkage Method	Upload to FTP/NAS/memory card, notify surveillance center, send email, trigger alarm output, trigger recording, trigger capture
General Function	Anti-banding, three streams, heartbeat, mirror, flash log, password reset via email, pixel counter
<b>Approval</b>	
EMC	CE-EMC (EN 55032: 2015+A11:2020+A1:2020, EN 50130-4: 2011+A1: 2014, EN IEC 61000-3-2:2019+A1:2021, EN 61000-3-3: 2013+A1:2019+A2:2021) UKCA (EN 55032: 2015+A11:2020+A1:2020, EN 50130-4: 2011+A1: 2014, EN IEC 61000-3-2:2019+A1:2021, EN 61000-3-3: 2013+A1:2019+A2:2021)
Environment	CE-RoHS (RoHS Directive 2011/65/EU+2015/863)
Protection	IP68 (IEC 60529-2013)

#### ▪ Available Model

DS-2XT6645G0-LIZS/C15(2.8-12mm)

▪ **Dimension**

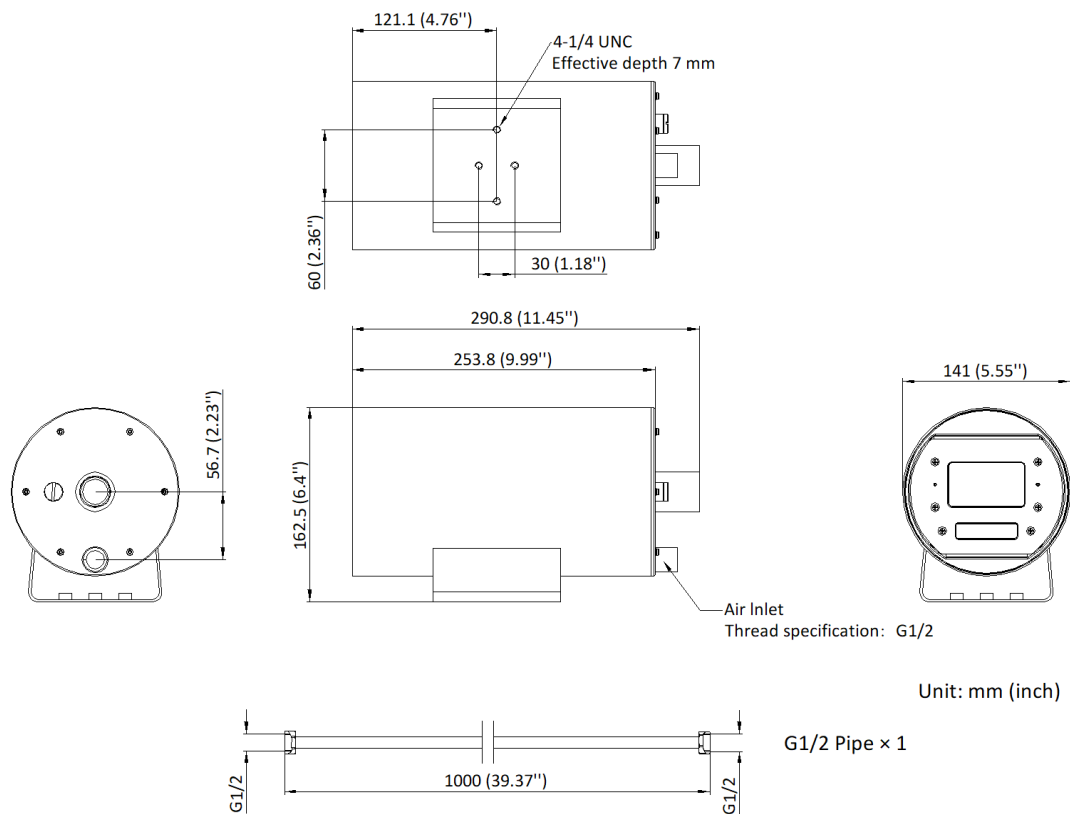

▪ **Accessory**

▪ **Optional**



**Headquarters**  
No.555 Qianmo Road, Binjiang District,  
Hangzhou 310051, China  
T +86-571-8807-5998  
www.hikvision.com



Follow us on social media to get the latest product and solution information.

